



We build a better future

■ Photo may include optional equipment

DIESEL FORKLIFT TRUCKS Environmental - Friendly

20D/25D/30D/33D-7E

 **HYUNDAI**
HEAVY INDUSTRIES EUROPE

FORKLIFT *Excellent* Model

20D/25D/30D/33D -7E

New criterion of Forklift Trucks

Hyundai introduces a new line of 7E-series diesel forklift trucks. Excellent power and performance make your business more profitable.





■ Photo may include optional equipment

High Power & Performance

Powerful Engine

KUBOTA V3600 Engine

The market approved quality of the Kubota V3600 engine ensures an incomparable performance, durability and additional value to the machine. 48kW of the engine is more than enough to suit any work, with a standard as well as a special attachment equipped machine. (EPA Int.Tier-4 / EU Stage IIIA Certified)

48 kW / 2,300 rpm



State-of-the-art hydraulic system

The latest designed, large-capacity hydraulic system including a low-noise control valve shortens reaction time during operation and improves both efficiency and durability.

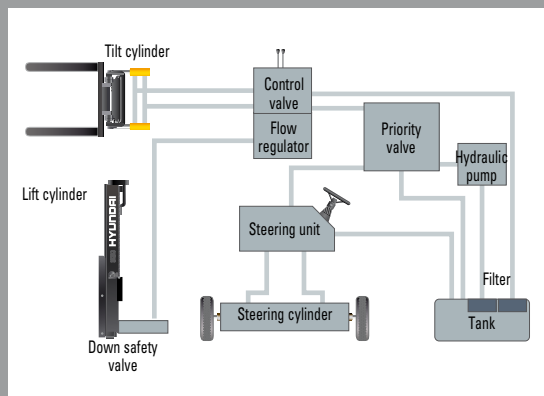

Fast and stable performance

Being able to quickly raise and lower the mast, as well as tilting forward and backward, the truck provides you the best operational conditions during loading/unloading operations. When the truck is fully loaded, mast lowering speed is carefully controlled to ensure safety by the down control valve.

The new master on your job-site!

Smooth running, efficient and ergonomically designed, 20/25/30/33D-7E series are made to meet your needs.



■ Photo may include optional equipment

Faster travel speed & Grade-ability

The powerful high-output engine provides greater acceleration, better grade-ability and faster travel speed on any tough terrain or slope.

Grade-ability (Loaded)

20D-7E	24.2%	30D-7E	17.3%
25D-7E	21.3%	33D-7E	15.8%

Travel speed (Unloaded)

20D-7E	18.4 km/h	30D-7E	19.3 km/h
25D-7E	18.4 km/h	33D-7E	19.3 km/h

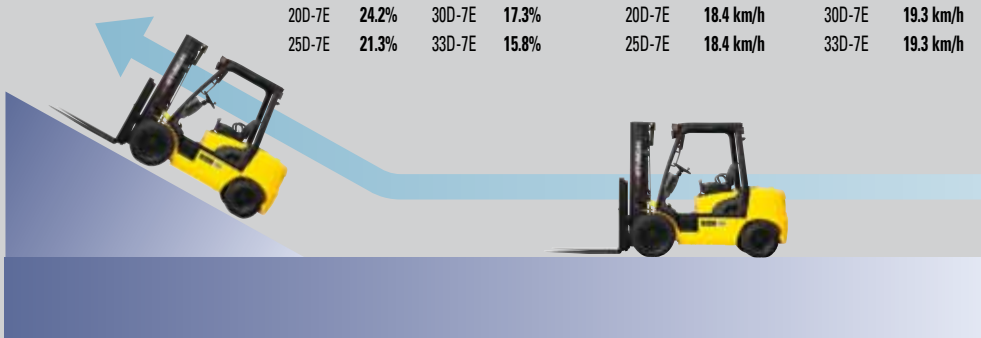

Increased mast tilting angle

Utilizing the mast tilting angle of 8 degrees forward and 10 degrees backward gives the operator a safe and rapid platform for loading and unloading jobs.



Wet disc brake system

Wet disc brakes improve the brake performance and make your service intervals longer. Enclosed brakes are protected against dust and water.



Fully hydrostatic power steering

A hydraulic steering system always guarantees smooth and flexible steering, preventing overrun and steering wheel kick-back.

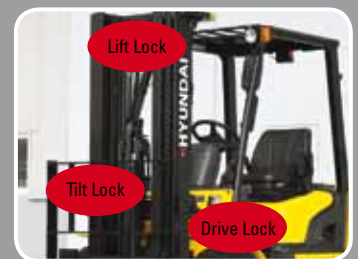

OPSS (Operator Presence Sensing System)

Mast tilting, lifting and lowering operation is not possible when the operator is not seated in normal position. (Option)

Comfortable Operation



Adjustable steering wheel

Steering wheel with horn button can be adjusted by a lever on the right-hand side for the most comfortable operator position.



Easy and safe shift lever

A single lever on the left side of the steering column gives the operator fast and easy control of travel direction. The engine can only be started in case of neutral position of this lever.



Multi-function switch lever

A multi-functional switch lever gives easy access to lights and horn.



Quick response of operating control levers

Only minimal operator's effort is required for precise, safe and productive control.



■ Photo may include optional equipment



Ergonomically positioned pedals

Based on human engineering, the accelerator, brake and inching pedals are optimally positioned for operator's convenience.



Cup holder & console box

Additional storage spaces are located inside the operating space for operator's convenience.

Comfortable Operation!

A design based on human engineering relieves fatigue and increases operator's efficiency.



New high visibility for safe operation

The operator is able to work with increased safety and accuracy due to a wider view mast.

Operator friendly gauges and water-resistant monitor panel



- ① Parking brake lamp
- ② Directional indicators
- ③ Fuel warning lamp
- ④ Engine oil warning lamp
- ⑤ Transmission oil temperature warning lamp
- ⑥ Battery warning lamp
- ⑦ Air filter warning light
- ⑧ Working light indicator
- ⑨ Water separator lamp
- ⑩ Pre-heater indicator
- ⑪ Water temperature gauge
- ⑫ Fuel gauge
- ⑬ Hour meter
- ⑭ Engine check lamp
- ⑮ Seat belt warning
- ⑯ OPSS warning

Easily adjustable suspension seat

An attractive and adjustable seat, based on a human engineering design, provides great comfort, safety and durability.



Full-floating overhead guard

Anti-vibration rubbers, installed between the guard and truck frame, reduce the source of vibration and noise while driving. This reduces operator's fatigue and increases safety.



Endurance & Safety

Strong overhead guard

The safety overhead guard meets EEC and ANSI regulations and protects the operator during hazardous jobs.



Parking brake

Ratchet type parking brake requires less effort from the operator to set.



Highly durable split type drive axle

The advanced drive axle always delivers the desired torque to the drive wheels



Safety through high durability!

Safety and durability are priorities in the design of the equipment.



Large footstep & handle

Wide "open" step offers convenience and safety when entering and exiting your truck.



■ Photo may include optional equipment

Heavy duty single unit frame

Heavy duty single unit type frame, designed on the basis of accurate structural analysis, guarantees durability and safety.

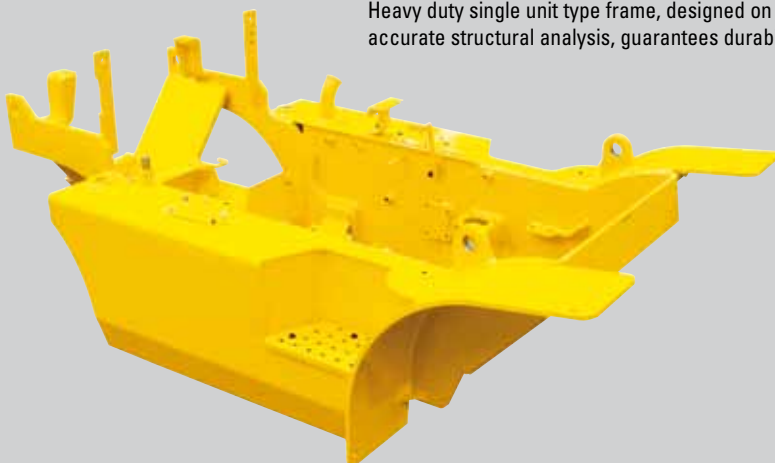

Easy access to electrical components

Various electric parts are centralized below the dash board resulting in improvement of maintenance.



Expansion bellows

The expansion bellows absorbs vibration and reduces noise generated from the exhaust gas to extend the life span.



Bright, protected headlights

Bright, protected headlights are positioned for increased visibility in dark environments.

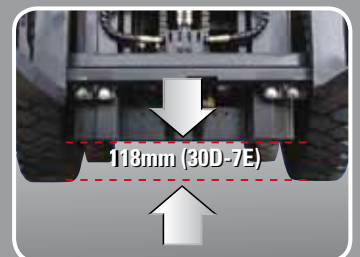

Ground clearance

The engine and transmission are assembled horizontally and positioned high in the frame to protect valuable components during operations on rugged surface.

High Durability & Easy Maintenance



Electrically monitored air filter

Air cleaner sensor alerts the operator of a restricted air filter so allowing replacement before a potential engine damage occurs.



Brake fluid reservoir

Highly visible, easily accessible reservoir makes for quicker daily inspections.



An accessible, compact fuse box for easy inspection

Centralized design for easy service!

An ideal arrangement of components ensures easy access and convenience during maintenance.



Battery master switch



Hydraulic oil check



Automatic self locking gas spring

Engine compartment hood is kept open by a self locking gas spring to improve maintenance safety.



Easy change of air cleaner

The air filter is readily accessible for cleaning or replacement. (7inch Cyclone Type)





■ Photo may include optional equipment



Large Open Engine Hood

Highly accessible engine compartment assures fast and efficient maintenance.



Easy maintenance oil check



Portable side cover check



Rotational battery installation

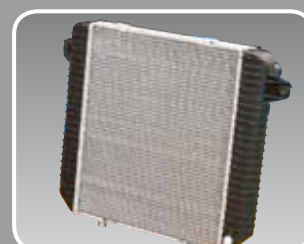

Aluminum radiator with superb protection against heat

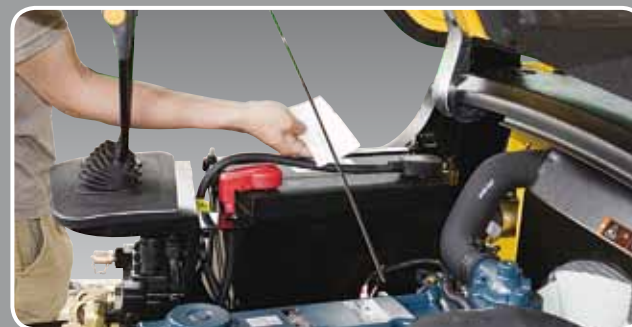

Quick and easy engine oil check

Mast Specifications (20D/25D/30D-7E)

Mast Type	Maximum Fork Height mm	Overall Height (Lowered) mm			Free Lift (mm)				Tilt Angle		Load Capacity without Side Shift 600mm LC (kg)						Load Capacity with Side Shift 600mm LC (kg)						Truck Weight Unload (kg)					
					With Backrest		Without Backrest				degree	Single Tire			Double Tire			Single Tire			Double Tire			Single Tire			Double Tire	
		20D-7E	25D-7E	30D-7E	20D-7E	30D-7E	20D-7E	25D-7E	30D-7E	Forward		Backward	20D-7E	25D-7E	30D-7E	20D-7E	25D-7E	30D-7E	20D-7E	25D-7E	30D-7E	20D-7E	25D-7E	30D-7E	20D-7E	25D-7E	30D-7E	20D-7E
2-Stage limited free lift	V300	3000	2025	2040	155	155	155	155	6	10	2000	2500	3000	2000	2500	3000	2000	2500	3000	2000	2500	3000	3552	3842	4359	3889	3979	4446
	*V330	3300	2175	2190	155	155	155	155	6	10	2000	2500	3000	2000	2500	3000	2000	2500	3000	2000	2500	3000	3572	3862	4379	3708	3998	4466
	V350	3500	2275	2290	155	155	155	155	6	10	2000	2500	3000	2000	2500	3000	2000	2500	3000	2000	2500	3000	3589	3879	4397	3725	4015	4484
	V370	3700	2425	2440	155	155	155	155	6	10	2000	2500	3000	2000	2500	3000	2000	2500	3000	2000	2500	3000	3611	3901	4420	3747	4037	4507
	V400	4000	2575	2590	155	155	155	155	6	10	2000	2500	3000	2000	2500	3000	2000	2475	2950	2000	2500	2975	3641	3931	4451	3777	4067	4538
	V430	4300	2725	2740	155	155	155	155	6	6	2000	2450	2925	2000	2500	3000	1950	2400	2875	2000	2450	2925	3693	3983	4504	3829	4119	4590
	V450	4500	2875	2890	155	155	155	155	6	6	2000	2400	2875	2000	2475	2950	1930	2350	2825	2000	2400	2875	3715	4005	4526	3861	4141	4613
	V470	4700	2975	2990	155	155	155	155	6	6	2000	2350	2825	2000	2450	2900	1900	2325	2750	2000	2375	2825	3729	4019	4541	3885	4165	4638
2-Stage full free lift	VF290	2900	2025	2040	845	860	1377	1314	6	6	2000	2500	3000	2000	2500	3000	2000	2500	3000	2000	2500	3000	3598	3888	4399	3735	4025	4486
	VF320	3200	2175	2190	895	1010	1527	1464	6	6	2000	2500	3000	2000	2500	3000	2000	2500	3000	2000	2500	3000	3632	3922	4435	3769	4059	4521
3-Stage full free lift	TF370/TS370	3700	1825	1840	645	660	1177	1114	6	6	2000	2500	3000	2000	2500	3000	2000	2450	2900	2000	2500	2950	3689	3979	4509	3826	4116	4586
	TF400/TS400	4000	1925	1940	745	760	1277	1214	6	6	2000	2450	2900	2000	2500	2975	1950	2400	2850	2000	2450	2900	3713	4003	4533	3850	4140	4619
	TF430/TS430	4300	2025	2040	845	860	1377	1314	6	6	2000	2375	2850	2000	2450	2900	1900	2350	2775	2000	2400	2825	3731	4021	4555	3868	4158	4641
	TF450/TS450	4500	2125	2140	945	960	1477	1414	6	6	2000	2350	2800	2000	2425	2850	1875	2325	2725	1950	2350	2775	3753	4043	4581	3890	4180	4667
	TF470/TS470	4700	2175	2190	995	1010	1527	1464	6	6	1950	2300	2775	2000	2375	2825	1850	2275	2675	1925	2300	2725	3766	4056	4595	3903	4193	4681
	TF500/TS500	5000	2275	2290	1095	1110	1627	1564	6	6	1900	2250	2700	1950	2325	2750	1800	2200	2600	1900	2275	2675	3788	4078	4617	3925	4215	4703
	TF550/TS550	5500	2475	2490	1295	1310	1827	1764	6	6	1825	1800	2600	1875	2250	2650	1725	1700	2525	1825	2200	2575	3828	4118	4662	3965	4255	4748
TF600/TS600	6000	2675	2690	1495	1510	2027	1964	6	6	1500	1250	1900	1825	2150	2550	1400	1150	1750	1775	2100	2475	3892	4182	4731	4029	4319	4817	
4-Stage full free lift	QF610	6115	2177	2175	997	955	1512	1449	3	3	1550	1650	1870	1580	1910	2400	1465	1585	1770	1515	1845	2300	4134	4424	4911	4272	4562	4987
	QF660	6615	2377	2375	1197	1195	1712	1649	3	3	1450	1550	1750	1490	1820	2280	1385	1685	1650	1425	1360	2180	4194	4484	4971	4332	4622	5047
	QF700	7015	2477	2475	1297	1295	1812	1749	3	3	1240	1300	1450	1400	1720	2170	1175	1110	1350	1270	2070	4224	4515	5001	4363	4653	5078	
	QF745	7465	2627	2625	1447	1445	1962	1899	3	3	1150	1200	1300	1300	1610	2040	1085	1020	1200	1235	1175	1940	4270	4560	5047	4469	4699	5123
QF790	7915	2777	2775	1597	1595	2112	2049	3	3	700	750	800	900	1000	1200	635	570	700	835	770	1100	4370	4661	5147	4509	4799	5224	

* TS-Mast : Wide Visible 3-Stage Full Free Lift Mast with 2 Free Lift Cylinders.

* standard

Mast Specifications (33D-7E)

Mast Type	Maximum Fork Height mm	Overall Height (Lowered) mm		Free Lift (mm)		Tilt Angle		Load Capacity without Side Shift 600mm LC (kg)		Load Capacity with Side Shift 600mm LC (kg)		Truck Weight Unload (kg)	
				With Backrest	Without Backrest			Single Tire	Double Tire	Single Tire	Double Tire	Single Tire	Double Tire
		33D-7E	33D-7E	33D-7E	33D-7E	Forward	Backward	33D-7E	33D-7E	33D-7E	33D-7E	33D-7E	33D-7E
2-Stage limited free lift	V290	2900	2040	155	155	6	10	3300	3300	3300	3300	4767	4858
	*V320	3200	2190	155	155	6	10	3300	3300	3300	3300	4791	4882
	V340	3400	2290	155	155	6	10	3300	3300	3300	3300	4807	4898
	V360	3600	2440	155	155	6	10	3300	3300	3300	3300	4830	4921
	V390	3900	2590	155	155	6	10	3300	3300	3300	3300	4862	4953
	V420	4200	2740	155	155	6	6	3300	3300	3275	3300	4916	5007
	V440	4400	2890	155	155	6	6	3275	3300	3200	3300	4940	5031
	V460	4600	2990	155	155	6	6	3225	3300	3150	3250	4955	5046
2-Stage full free lift	VF290	2900	2090	910	1269	6	6	3300	3300	3300	3300	4805	4896
	VF320	3200	2240	1060	1419	6	6	3300	3300	3300	3300	4841	4932
3-Stage full free lift	TF370/TS370	3700	1890	710	1069	6	6	3300	3300	3300	3300	4948	5039
	TF400/TS400	4000	1990	810	1169	6	6	3275	3300	3200	3300	4970	5061
	TF430/TS430	4300	2090	910	1269	6	6	3200	3300	3150	3225	4991	5082
	TF450/TS450	4500	2190	1010	1369	6	6	3150	3250	3075	3175	5013	5104
	TF470/TS470	4700	2240	1060	1419	6	6	3100	3200	3025	3125	5026	5117
	TF500/TS500	5000	2340	1160	1519	6	6	3050	3125	2950	3050	5049	5140
	TF550/TS550	5500	2540	1360	1719	6	6	2700	3000	2450	2925	5092	5183
TF600/TS600	6000	2740	1560	1919	6	6	1750	2900	1450	2825	5165	5256	
4-Stage full free lift	QF610	6115	2225	1045	1449	3	3	1950	2830	1850	2730	5296	5372
	QF660	6615	2425	1245	1649	3	3	1850	2700	1750	2600	5356	5433
	QF700	7015	2525	1345	1749	3	3	1550	2580	1450	2480	5386	5462
	QF745	7465	2675	1495	1899	3	3	1000	2440	900	2340	5428	5505
QF790	7915	2825	1645	2049	3	3	600	1300	500	1200	5532	5609	

* TS-Mast : Wide Visible 3-Stage Full Free Lift Mast with 2 Free Lift Cylinders.

* standard

Load Capacity

20D-7E

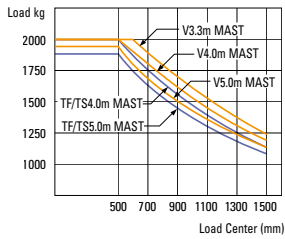

25D-7E

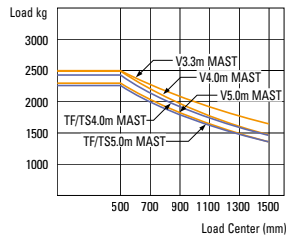

30D-7E

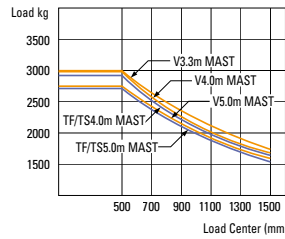

33D-7E

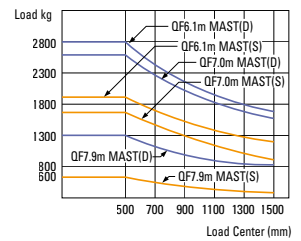
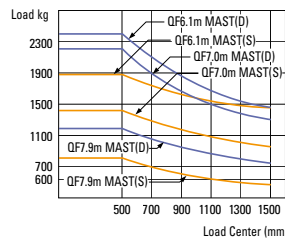
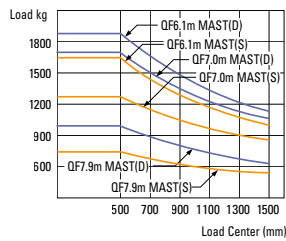
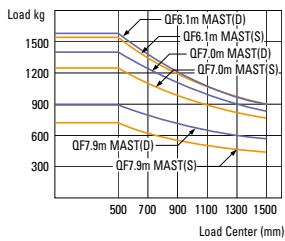
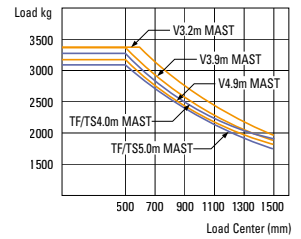

Various Attachments



Side Shift

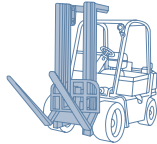

Hinged Forks

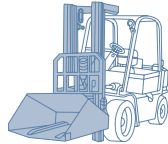

Hinged Bucket

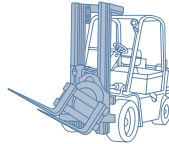

Rotating Forks

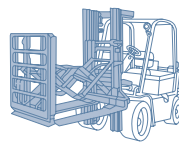

Push Pull

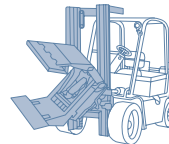

Rotating Roll Clamp

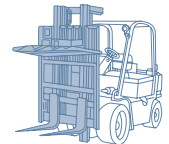

Load Stabilizer

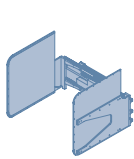

Carton Clamp

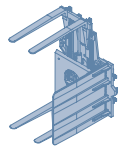

Pallet Invert

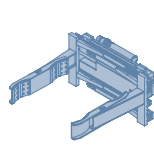

Drum Clamp

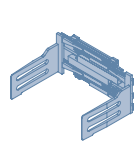

Bale Clamp

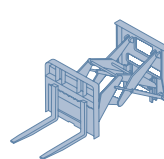

Load Extender

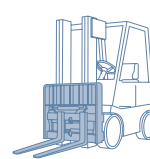

Fork Positioner

Optional Items

• FORK (L x W x T) (mm)

20D / 25D-7E

900 x 100 x 45	1000 x 100 x 45	1050 x 100 x 45
1200 x 100 x 45	1350 x 100 x 45	1500 x 100 x 45
1650 x 100 x 45	1800 x 100 x 45	

30D / 33D-7E

900 x 122 x 45	1150 x 122 x 45	1050 x 122 x 45
1200 x 122 x 45	1350 x 122 x 45	1500 x 122 x 45
1650 x 122 x 45	1800 x 122 x 45	2400 x 122 x 45
2120 x 122 x 45	1970 x 122 x 45	2300 x 122 x 45

• Overshoe (mm)

1300 / 1500 / 1700 / 1800

• Tilting (6°/10°, 6°/6°, 3°/3°)

• Sideshift

• Integral Sideshift

• Attach Piping (3-Spool piping / 4-Spool piping)

• Hose - Reel (VF)

• Exhaust (Horizontal / Vertical)

• Muffler (Spark Arrester)

• Seat (Seat Belt, Arm rest, Hip rest)

• Tire (Cushion, No-Marking, Double)

• MCV (3-Spool / 4-Spool)

• Beacon Lamp

• Work Lamp

• Cabin & Heater

Notes

Lined area for notes, consisting of multiple horizontal lines.

Dimensions

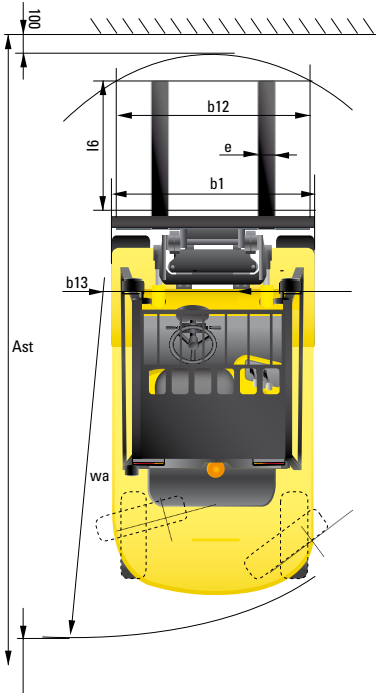
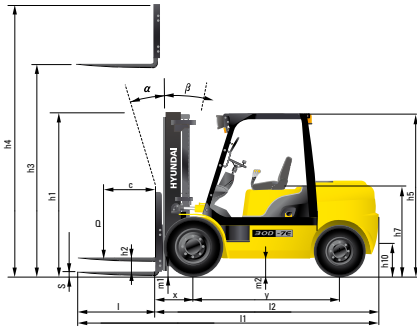

Specifications

Identification					
1.1	Manufacturer	Hyundai	Hyundai	Hyundai	Hyundai
1.2	Type	20D-7E	25D-7E	30D-7E	33D-7E
1.3	Drive: electric (battery or mains), diesel, petrol, fuel gas, manual	DIESEL	DIESEL	DIESEL	DIESEL
1.4	Type of operation: hand, pedestrian, standing, seated, order-picker	seated	seated	seated	seated
1.5	Load capacity (standard)	kg 2000	2500	3000	3300
1.6	Load center distance	c (mm) 500	500	500	500
1.8	Load distance, center of drive axle to forks	x (mm) 461	461	464	464
1.9	Wheelbase	y (mm) 1650	1650	1700	1700
Weights					
2.1	Service weight	kg 3604	3894	4411	4823
2.2	Axle loading, loaded front/rear	kg 4847 / 757	5579 / 815	6450 / 961	6885 / 1238
2.3	Axle loading, unloaded front/rear	kg 1683 / 1921	1623 / 2271	1748 / 2663	1713 / 3110
Wheels, chassis					
3.1	Tires: solid rubber, superelastic, pneumatic, polyurethane	pneumatic	pneumatic	pneumatic	pneumatic
3.2	Tires size, front	7.00 - 12 - 12PR	7.00 - 12 - 12PR	28x9 - 15 - 14PR	28x9 - 15 - 14PR
3.3	Tires size, rear	6.00 - 9 - 10PR	6.00 - 9 - 10PR	6.50 - 10 - 12PR	6.50 - 10 - 12PR
3.5	Wheels, number front / rear (X= driven wheels)	2x / 2	2x / 2	2x / 2	2x / 2
3.6	Track width, front	b10 (mm) 965	965	1005	1005
3.7	Track width, rear	b11 (mm) 980	980	980	980
Basic dimensions					
4.1	Mast/fork carriage tilt forward/backward (α / β)	degrees	6 / 10	6 / 10	6 / 10
4.2	Lowered mast height (standard)	h1 (mm) 2175	2175	2190	2190
4.3	Free lift	h2 (mm) 155	155	155	155
4.4	Lift height (standard)	h3 (mm) 3300	3300	3300	3200
4.5	Extended mast height (standard)	h4 (mm) 4485	4485	4485	4385
4.7	Overhead load guard (cab) height	h5 (mm) 2160	2160	2180	2180
4.8	Seat height / standing height	h7 (mm) 1110	1110	1130	1130
4.12	Coupling height	h10 (mm) 283	283	299	299
4.19	Overall length	l1 (mm) 3584	3644	3742	3782
4.20	Length to face of forks	l2 (mm) 2534	2594	2692	2732
4.21	Overall width	b1 (mm) 1160	1160	1230	1230
4.22	Fork dimensions LxWxT	l x e x s (mm) 1050 x 100 x 45	1050 x 100 x 45	1050 x 122 x 45	1050 x 122 x 45
4.23	Fork carriage ISO 2328, class / type A, B	2A	2A	3A	3A
4.24	Fork carriage width	b12 (mm) 1102	1102	1102	1102
4.31	Ground clearance, loaded, under mast	m1 (mm) 130	130	145	145
4.32	Ground clearance, centre of wheelbase	m2 (mm) 171	171	189	189
4.33	Aisle width for pallets 1000 x 1200 crossways (L x W)	Ast (mm) 3916	3970	4066	4102
4.34	Aisle width for pallets 800 x 1200 lengthways (W x L)	Ast (mm) 4116	4170	4266	4302
4.35	Turning radius	Wa (mm) 2248	2302	2398	2434
4.36	Smallest pivot point distance	b13 (mm) 714	714	731	731
Performance data					
5.1	Travel speed, unloaded	km/h 18.4	18.4	19.3	19.3
5.2	Lift speed, loaded/unloaded	mm/s 560 / 590	540 / 590	480 / 500	470 / 500
5.3	Lowering speed, loaded/unloaded	mm/s 500 / 450	500 / 450	500 / 450	500 / 450
5.5	Drawbar pull, loaded	kg 2568	2591	2464	2472
5.7	Gradient performance, loaded/unloaded	% 45.0 / 24.8	39.0 / 22.1	31.2 / 21.0	28.3 / 18.7
5.9	Acceleration time, loaded/unloaded (10m)	sec NA	NA	NA	NA
5.10	Service brake	FOOT	FOOT	FOOT	FOOT
Engine					
6.1	Engine manufacturer / type	KUBOTA V3600	KUBOTA V3600	KUBOTA V3600	KUBOTA V3600
6.2	Engine power acc. To ISO 1585	kW 48	48	48	48
6.3	Rated speed	1/min 2300	2300	2300	2300
6.4	No. of cylinder / cubic capacity	anz / cm ³ 4 / 3620	4 / 3620	4 / 3620	4 / 3620
6.5	Fuel consumption acc. to VDI cycle	l/h 2.1	2.2	2.5	2.8
Other details					
8.1	Type of drive control	power shift	power shift	power shift	power shift
8.2	Operating pressure (attachments)	bar 205 / 170	205 / 170	205 / 170	205 / 170
8.3	Hydraulic oil flow (attachments)	l/min 30	30	30	30
8.4	Sound level at driver's ear according to DIN 12053	db(A) 80	80	80	80

- * Standard and optional equipment may vary. Contact your Hyundai dealer for more information. The machine may vary according to international standards.
- * The photos may include attachments and optional equipment that are not available in your area.
- * Materials and specifications are subject to change without advance notice.
- * All imperial measurements rounded off to the nearest pound or inch.

PLEASE CONTACT

 **HYUNDAI**
HEAVY INDUSTRIES EUROPE
CONSTRUCTION EQUIPMENT